

## BUSINESS SCHOOL - CAMPUS JUAN XXIII

- 1 ACCESOS / MAIN ENTRANCE
- 2 AUDITORIO / AUDITORIUM
- 3 CAFETERIA / COFFEE SHOP
- 4 ASCENSORES
- 5 ASEOS / RESTROOMS
- 6 SECRETARÍA / SECRETARY
- 7 DESARROLLO PROFESIONAL / PROFESSIONAL DEVELOPMENT
- 8 ADMINISTRACIÓN / ADMINISTRATION
- 9 ADMISIONES / ADMISSIONS



PLANTA BAJA

## BUSINESS SCHOOL - CAMPUS JUAN XXIII

- 1 AULAS / CLASSROOMS 1.01-1.04
- 2 AULAS / CLASSROOMS 1.05-1.07
- 3 AULAS / CLASSROOMS 1.08-1.011
- 4 AULAS / CLASSROOMS 1.12-1.13
- 5 ÁGORA / MULTIDISCIPLINARY ROOM
- 6 MEETING POINTS 1
- 7 MEETING POINTS 2
- 8 MEETING POINTS 3
- 9 SALAS DE TRABAJO GRUPAL / STUDY ROOMS
- 10 MANAGEMENT
- 11 ASEOS FEMENINOS / WOMEN RESTROOMS
- 12 ASEOS MASCULINOS / MEN RESTROOMS
- 13 ASCENSORES / ELEVATORS



# BUSINESS SCHOOL - CAMPUS JUAN XXIII

- 1 AULAS/CLASSROOMS 2.01-2.04
- 2 AULAS/CLASSROOMS 2.05-2.07
- 3 AULAS/CLASSROOMS 2.08-2.011
- 4 AULAS/CLASSROOMS 2.12-2.013
- 5 AULAS/CLASSROOMS 2.14-2.015
- 6 TERRAZA/ ROOFTOP TERRACE
- 7 MEETING POINTS 1
- 8 MEETING POINTS 2
- 9 SALAS DE TRABAJO GRUPAL/ STUDY ROOMS
- 10 GIMNASIO/GYM
- 11 VESTUARIO FEMENINO/ FEMALE CHANGING ROOM
- 12 VESTUARIO MASCULINO/ MALE CHANGING ROOMS
- 13 VESTUARIO ACCESIBLE
- 14 ASEOS MASCULINOS / MEN RESTROOMS
- 15 ASEOS FEMENINOS / WOMEN RESTROOMS
- 16 ASCENSORES/ELEVATORS

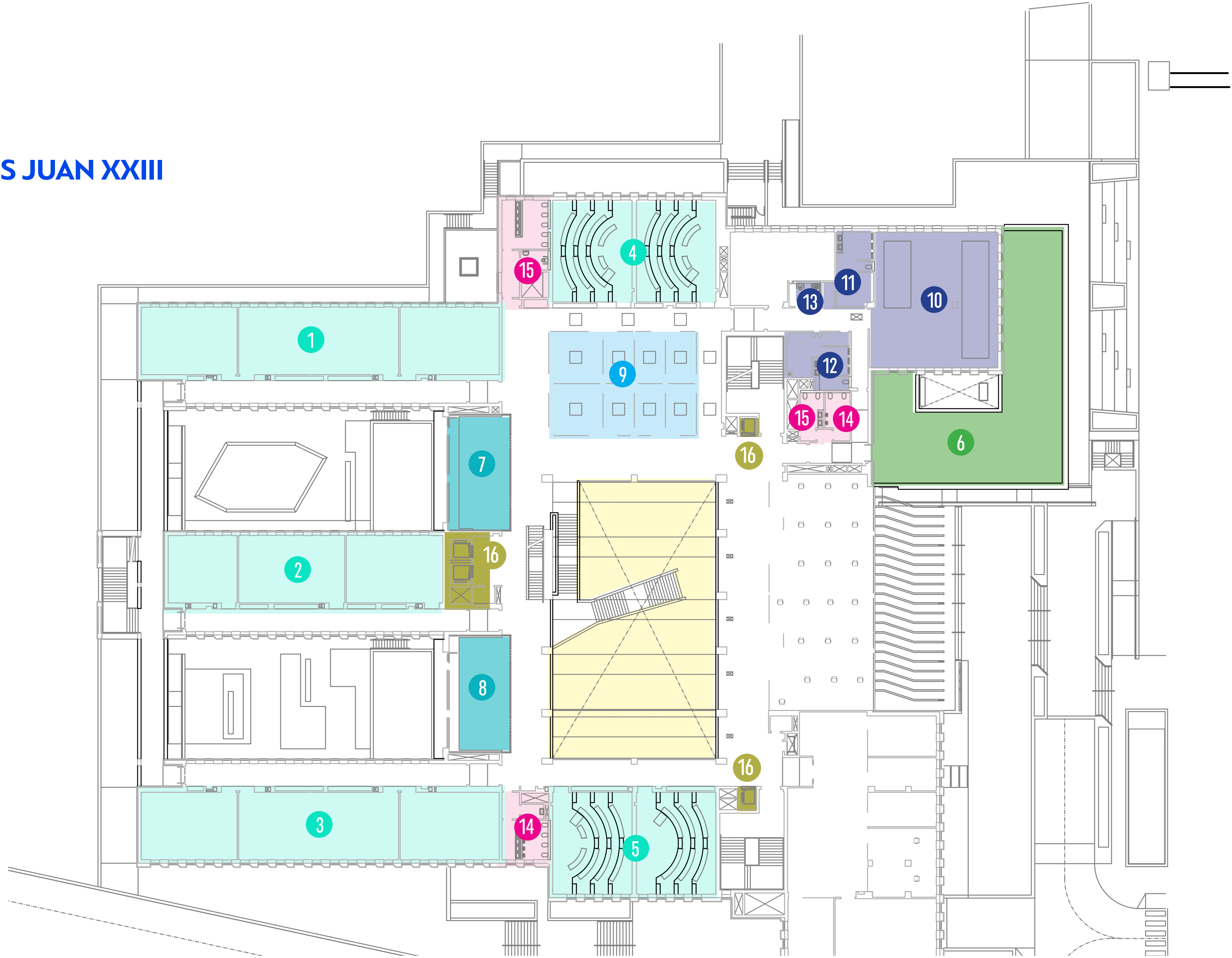

## BUSINESS SCHOOL - CAMPUS JUAN XXIII

- 1 AULAS / CLASSROOMS 3.01-3.04
- 2 AULAS / CLASSROOMS 3.05-3.07
- 3 AULAS / CLASSROOMS 3.08-3.11
- 4 MEETING POINTS 1
- 5 ASEOS MASCULINOS / MEN RESTROOMS
- 6 ASEOS FEMENINOS / WOMEN RESTROOMS
- 7 ASCENSORES/ELEVATORS

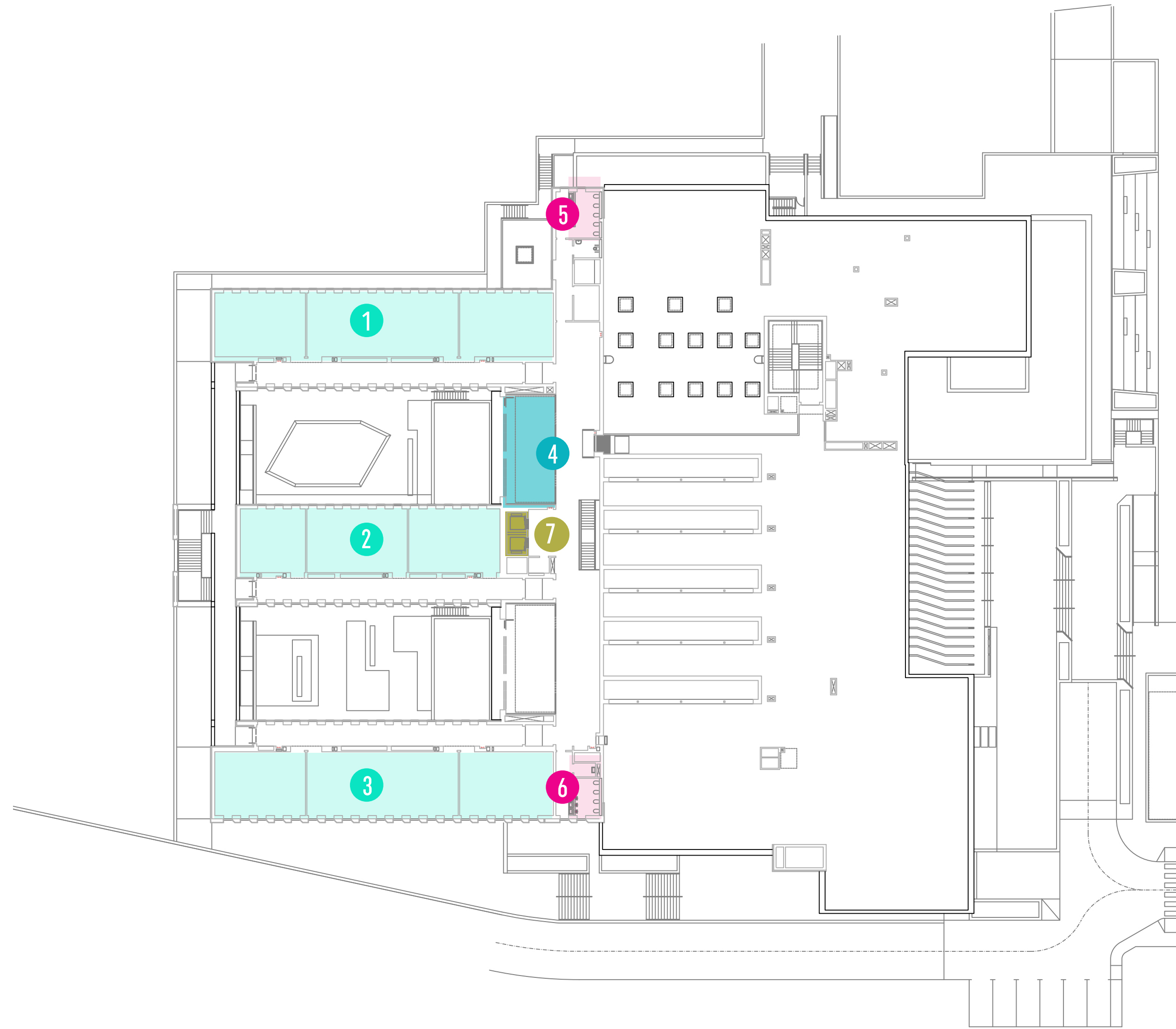

TERCERA PLANTA